

\$139,900 - 32 52515 Rge Road 52, Rural Parkland County

MLS® #E4435728

\$139,900

0 Bedroom, 0.00 Bathroom,
Rural on 0.29 Acres

Sundance Meadows, Rural Parkland County,
AB

Welcome to this incredible 0.29-acre vacant lot, nestled in the cozy Subdivision of Sundance Meadows. This large hillside lot, overlooking Lake Wabamun is just steps away from its serene shores. Whether you're looking to build your dream summer cottage, a four-season paradise, or a place to park your RV, you've found the perfect blend of tranquility and convenience. Backing onto a Municipal Reserve to the west (no neighbors!), to the East you'll find another Municipal Reserve, providing unobstructed views of the sunrise from your future porch! Easy lake access, just a 3 min walk, lets you enjoy boating, fishing, kayaking, swimming or simply relaxing. Conveniently located off Hwy 16, it's an easy commute to the capital city and nearby amenities. Only minutes to Seba beach corner store, summer farmer's market, shopping in Wabamun or golf at nearby Pineridge. Ready-to-enjoy lots like this are rare in small subdivisions with lake access. Don't miss the opportunity to love lake life living today!

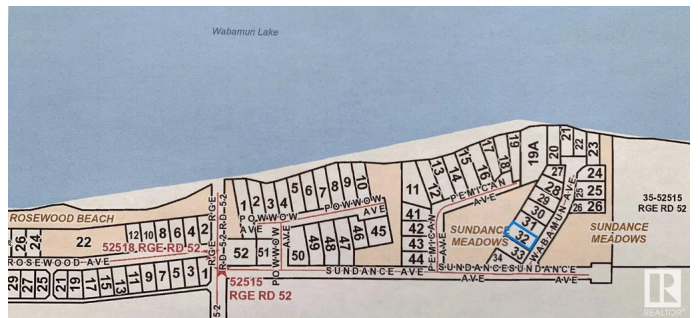

Essential Information

MLS® # E4435728

Price	\$139,900
Bathrooms	0.00
Acres	0.29
Type	Rural
Sub-Type	Vacant Lot/Land
Status	Active

Community Information

Address	32 52515 Rge Road 52
Area	Rural Parkland County
Subdivision	Sundance Meadows
City	Rural Parkland County
County	ALBERTA
Province	AB
Postal Code	T0E 2B0

Exterior

Exterior Features	Boating, Cul-De-Sac, Golf Nearby, Hillside, Lake Access Property, Low Maintenance Landscape, No Through Road, Park/Reserve, Private Setting
-------------------	---

Additional Information

Date Listed	May 9th, 2025
Days on Market	86
Zoning	Zone 93

DATA IS DEEMED RELIABLE BUT IS NOT GUARANTEED ACCURATE BY THE REALTORS® ASSOCIATION OF EDMONTON. COPYRIGHT 2025 BY THE REALTORS® ASSOCIATION OF EDMONTON. ALL RIGHTS RESERVED. Trademarks are owned or controlled by the Canadian Real Estate Association (CREA) and identify real estate professionals who are members of CREA (REALTOR®, REALTORS®) and/or the quality of services they provide (MLS®, Multiple Listing Service®)

Listing information last updated on August 3rd, 2025 at 3:47pm MDT